

**SS-3300-RUTAIL-PXX-PYY**

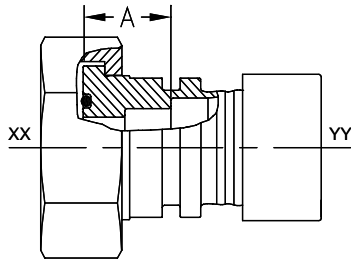

National Stock #	Fitting Size PXX-PYY	Piece Number	Take - Out, A	Thread	Across Flats
	P08-P06	9062659	1.32	1 3/4-12UN	2.00
	P12-P08	9062557	1.34	2-12 UN	2.25
	P20-P16	9061899	1.53	2 3/4-12 UN	3.00

\*Complete with BUNA-N O-Ring

\*Thread and seal face conform to Navy dwg 803-1385884

**SS-3300-1183 UTAIL-PXX**

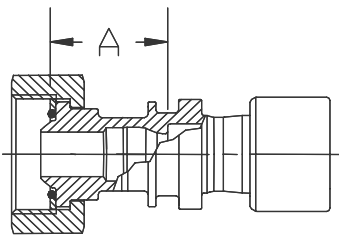

National Stock #	Fitting Size PXX	Piece Number	Take - Out, A	Thread	Across Flats
	P04	9062138	1.04	1.089-16-UNS-2A	1.34
	P06	9062528	1.08	1.281-14-UNS-B	1.54
	P08	9062529	1.05	1.491-14-UNS-B	1.78
	P12	9062530	1.10	1.835-11-UNS-B	2.16
	P16	9062531	1.13	2.165-11-UNS-B	2.54
	P20	9062532	1.24	2.601-10-UNS-B	3.04
	P24	9062533	1.20	2.921-10-UNS-B	3.39
	P32	consult Lokring	1.85	3.521-10-UNS-B	4.00

\*Seal face conforms to MIL-F-1183

**SS-3300-UNION-PXX**

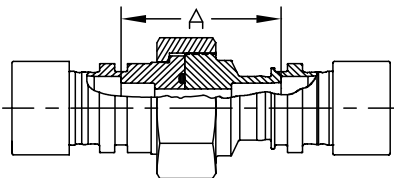

National Stock #	Fitting Size PXX	Piece Number	Take - Out, A	Thread
	P04	9061351	2.82	1-3/16-12UN
	P06	9061352	2.94	1-3/8-12UN
	P08	9061353	2.91	1-3/4-12UN
	P12	9061354	2.97	2 -12 UN
	P16	9061355	3.22	2-5/16-12NS
	P20	9061356	3.44	2-3/4-12UN
	P24	9061357	3.83	3-1/16-12NS
	P32	consult Lokring	4.07	3-3/4-12UN

\*Complete with BUNA-N O-Ring

\*Thread and seal face conform to Navy dwg 803-1385884

**SS-3300-ADPT-PXX-YY SAE (M)**

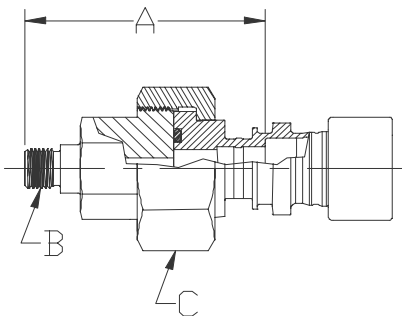

Fitting Size PXX-YY SAE (M)	Piece Number	Take - Out, A	Across Flats	Across Flats	Thread B	Thread C
P08-0.375	9062621	3.26	1.25	2.00	9/16 - 18 UNF	1 3/4-12 UN

\*Complete with BUNA-N O-Ring

\*Thread and seal face of C conform to Navy dwg 803-1385884

\*Thread B conforms to SAE J1926/2