

SS-3300-REDB-PXX-YY NPS

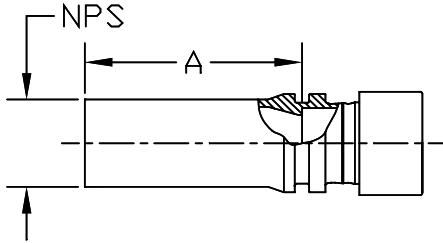

National Stock #	Fitting Size PXX-YY NPS	Piece Number	Take - Out, A
	P04-3/8	9061222	2.30
	P04-1/2	9061220	2.43
	P06-1/2	9061221	2.54
	P06-3/4	9062500	2.31
	P08-3/4	9062015	2.98
	P08-1	9061909	3.67
	P12-1	9061945	3.56
	P12-1 1/4	9061893	4.78
	P16-1 1/4	9061917	4.12
	P16-1 1/2	9061908	5.07
	P16 - 2	consult Lokring	
	P20-1 1/2	9062016	4.22
	P24-2	consult Lokring	6.41

SS-3300-UTHRD-PXX

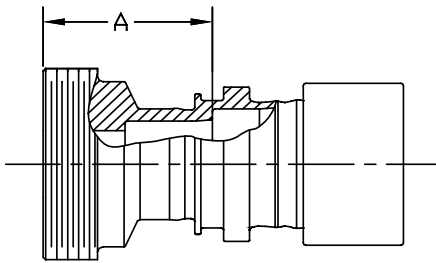

National Stock #	Fitting Size PXX	Piece Number	Take - Out, A	Thread	Across Flats
	P04	8061446	1.58	1-3/16-12UN	15/16
	P06	8061452	1.64	1-3/8-12UN	1-1/6
	P08	8061458	1.66	1-3/4-12UN	1-1/4
	P12	8061461	1.69	2 -12UN	1-5/8
	P16	8061467	1.94	2-5/16-12NS	2.00
	P20	8061473	2.11	2-3/4-12UN	2-3/8
	P24	8061479	2.43	3-1/16-12NS	2-5/8
	P32	consult Lokring	2.63	3-3/4-12UN	3-3/16

*Thread and seal face conform to Navy dwg 803-1385884

SS-3300-UTAIL-PXX

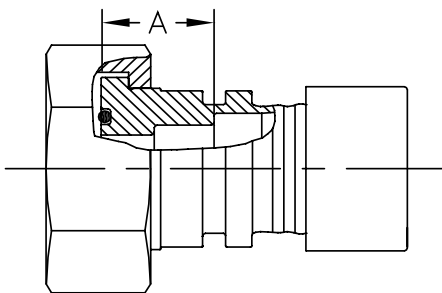

National Stock #	Fitting Size PXX	Piece Number	Take - Out, A	Thread	Across Flats
	P04	8061449	1.24	1-3/16-12UN	1-3/8
	P06	8061455	1.30	1-3/8-12UN	1-5/8
	P08	9061283	1.25	1-3/4-12UN	2.00
	P12	8061464	1.28	2 -12UN	2-1/4
	P16	8061470	1.28	2-5/16-12NS	2-9/16
	P20	8061476	1.33	2-3/4-12UN	3.00
	P24	8061482	1.40	3-1/16-12NS	3-1/2
	P32	consult Lokring	1.48	3-3/4-12UN	4-1/8

*Complete with BUNA-N O-Ring

*Thread and seal face conform to Navy dwg 803-1385884